

# FOR LEASE

## The Shoppes at Foxland

1867 Nashville Pike  
Gallatin, TN 37066



**JP POWELL**  
Principal Broker, SIOR

C 615.533.5682  
O 615.824.7072

[jpowell@southeasterncommercial.net](mailto:jpowell@southeasterncommercial.net)

**AMANDA FOSTER**  
Managing Broker

C 615.420.0677  
O 615.824.7072

[afoster@southeasterncommercial.net](mailto:afoster@southeasterncommercial.net)

# KEY FACTS

- 1,175-8,463 Square feet available
- Average Household Income within 1 mile - \$135,531, 3 miles - \$121,761, 5 miles - \$105,436
- Total Population 1 mile - 5,924, 3 miles - 25,227, 5 miles - 69,193
- Nashville Pike AADT - 30,000 + Cars Per Day
- Adjacent to Foxland Crossings - 400 Apartments
- Nashville Pike Road Frontage

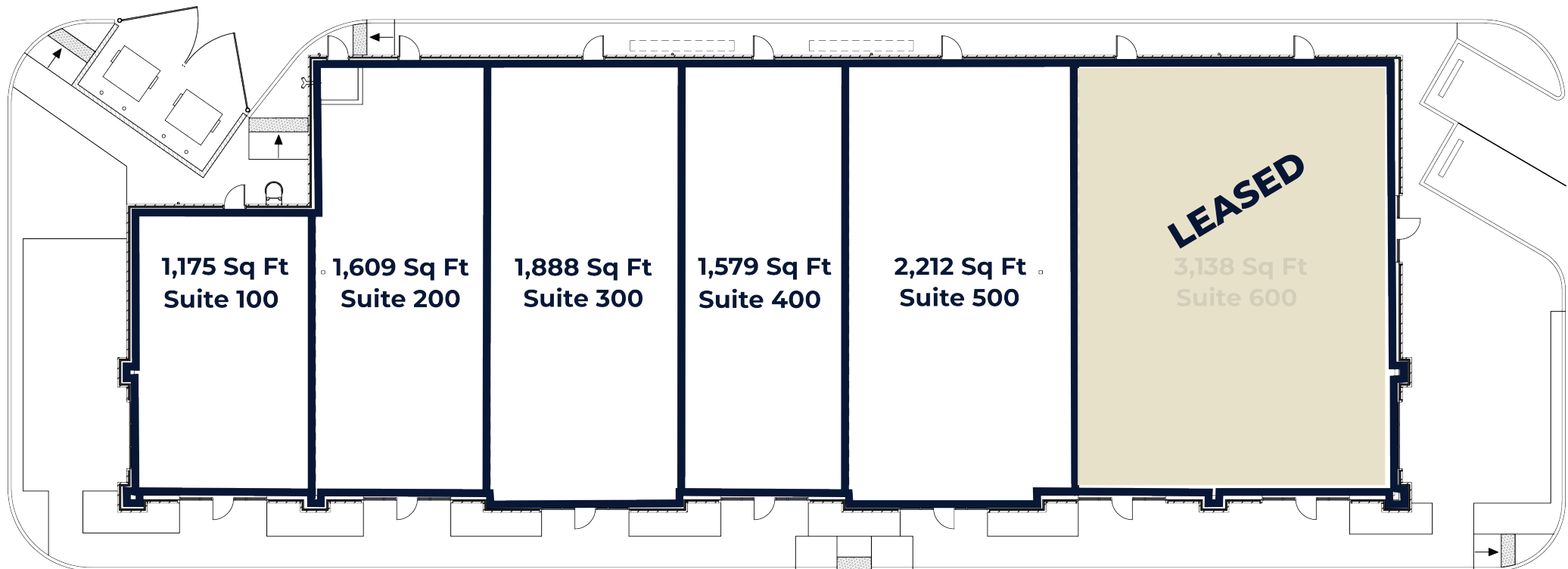
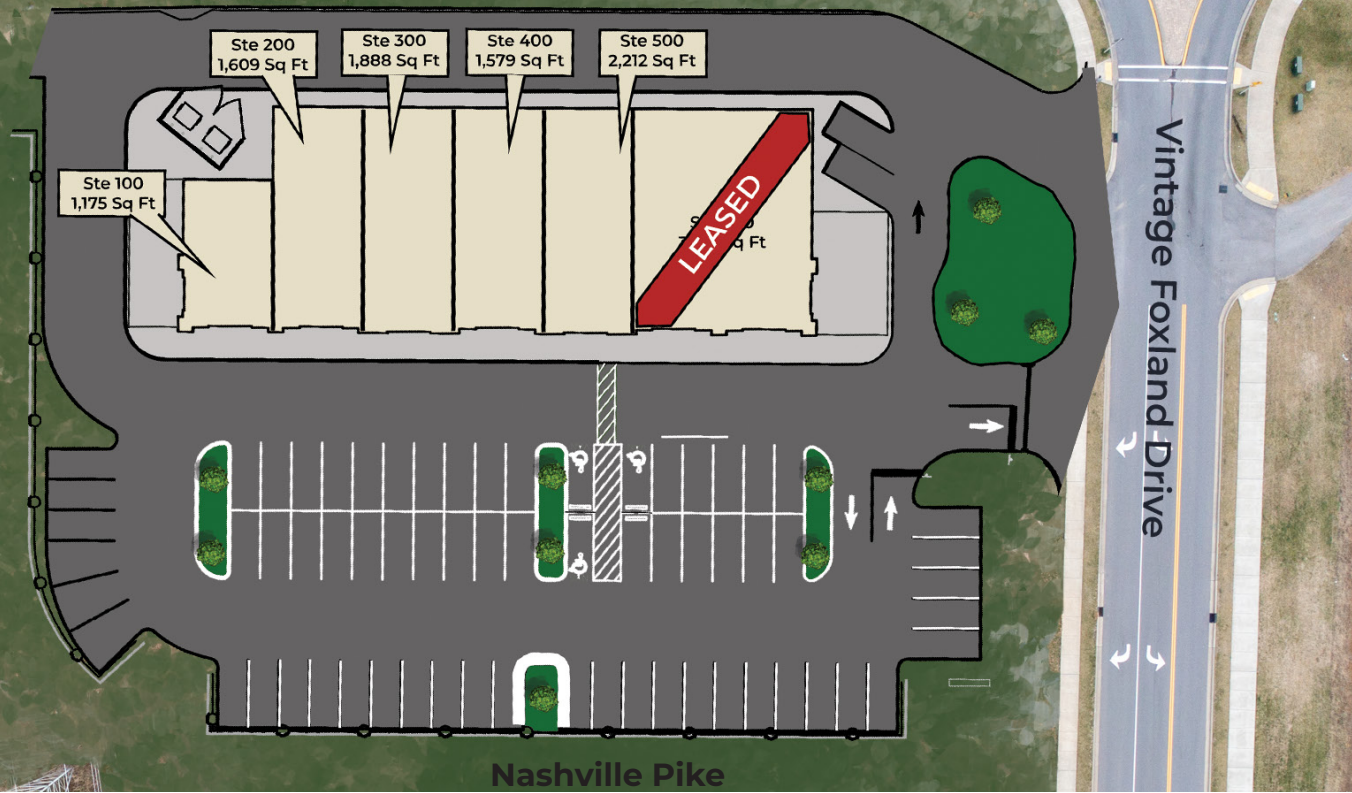

## SUMNER COUNTY DESCRIPTION

Sumner County is the third most affluent and one of the fastest-growing counties in the state of Tennessee. This is mainly because of a highly ranked school system, business community anchored by large manufacturing and distribution operations, and its unique location with 63 miles of shoreline.

Located only 24 miles north of downtown Nashville and 27 miles from Nashville's International Airport.

## SUMNER COUNTY FACTS

### POPULATION

#### MEDIAN AGE

1 mile - 46.4  
3 miles - 42.9  
5 miles - 40.5

#### FAMILIES

1 mile - 1,674  
3 miles - 7,425  
5 miles - 18,980

#### FEMALES

1 mile - 2,194  
3 miles - 13,146  
5 miles - 34,971

#### MALES

1 mile - 2,188  
3 miles - 12,677  
5 miles - 33,578

### INCOME

#### AVERAGE DISPOSABLE INCOME

1 mile - \$104,092  
3 miles - \$95,179  
5 miles - \$84,118

#### AVERAGE INCOME

1 mile - \$135,531  
3 miles - \$121,761  
5 miles - \$105,436

### CONSUMER SPENDING

#### APPAREL

1 mile - \$2,971  
3 miles - \$2,700  
5 miles - \$2,383

#### ENTERTAINMENT

1 mile - \$4,624  
3 miles - \$4,173  
5 miles - \$3,673

#### FOOD AWAY FROM HOME

1 mile - \$5,239  
3 miles - \$4,792  
5 miles - \$4,237

#### PERSONAL CARE

1 mile - \$1,280  
3 miles - \$1,160  
5 miles - \$1,018





**JP POWELL**

Principal Broker, SIOR

C 615.533.5682

O 615.824.7072

[jpowell@southeasterncommercial.net](mailto:jpowell@southeasterncommercial.net)



**AMANDA FOSTER**

Managing Broker

C 615.420.0677

O 615.824.7072

[afoster@southeasterncommercial.net](mailto:afoster@southeasterncommercial.net)

**Southeastern**  
COMMERCIAL PROPERTIES

383 E Main St, Ste 120  
Hendersonville, TN 37075  
Office: 615.824.7072  
[www.scptn.net](http://www.scptn.net)